



1000 Lumen Connected Emergency Lighting Kit
 Provides Emergency Lighting From the Internal Battery
 Upon Loss of AC Power
 For Use With Most Luminaire Types and Independent of the
 Luminaire Components
 Works with FirstLink Connected Emergency Lighting System



Project: _____
 Location: _____
 Cat.No: _____
 Type: _____
 Qty: _____
 Notes: _____

Product order number:
 BLK1000T3UK55FL1

12 NC number:
 913702498501

Specifications

UL Classified for US and Canada

Classified for Field or Factory Installation
 (Indoor and Damp)

California Title 20

Meets CEC Title 20 requirements for installation in
 California

Initial Emergency Light Output

1000+ lumens (with LED module supplied)

Illumination Time

90 Minutes Minimum

Input Voltage

120 - 277 Vac 50/60 Hz

Battery

Integral Lithium-Ion Pack

Recharge Time

24 Hours

Wireless range¹

40' (typical minimum)
 80' (line of sight)

FirstLink Node Power Supply

60 mA (max), 52mA (guaranteed)
 UL insulation system 130B, Class 2 per UL 1310

Test Switch/Charging Indicator Light

Two-Wire, Bi-Color Illuminated Test Switch²
 IP65 rated for ingress protection to dust and
 water jets
 UL 2043 plenum rated test switch cable assembly

Temperature Rating (Ambient)

Ambient: 0-55°C (32-131°F)
 Case Tc (max): 63°C

Surge Rating

2.5kV NEMA/ANSI C82.77-5-2017 (indoor)

Dimensions

Driver:
 14.1" H x 1.18" W x 1.0" D (358 mm x 30 mm x 25 mm)
 Mounting Center 13.78" (350 mm)

LED Module:
 5.0" H x 1.0" W (127 mm x 25 mm)
 Mounting Center 2.65" (67.4 mm)

Weight

1.85 lbs. (0.84 kg)

Warranty

5 Years

1 - Wireless range can be impacted by many factors, which must be taken into account during the system design.
 2 - The bi-color illuminated test switch is a Class 2 device.



Benefits

- Compact two part solution (EM driver with integral battery and LED module)
- Fully field installable and includes everything needed for the complete installation
- Simple installation inside of existing luminaire - no modification to luminaire components needed
- Provides fast and easy emergency lighting with most existing luminaires and light sources
- Meets Title 20 CEC (California Energy Commission) efficiency standards
- ABConnect for simple, foolproof installation
- FirstLink compatible for automated testing and reporting when used with communication node in bracket provided

Dimensions

Driver: 14.1"H x 1.18"W x 1.0"D (Mounting Center - 13.78")

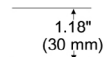
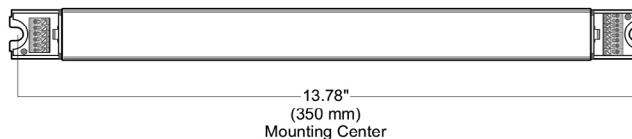
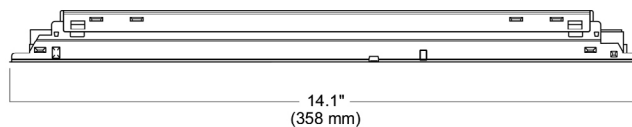

LED Module: 5.0"H x 1.0"W (Mounting Center - 2.65")

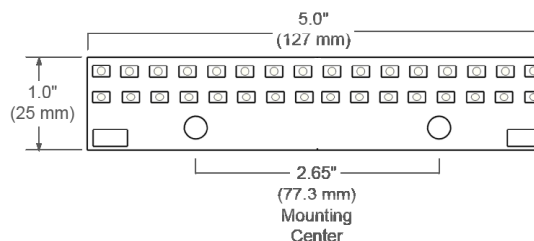

Dim.	Tolerance
L	± 0.02" (0.5 mm)
W	± 0.02" (0.5 mm)
H	+ 0.1" (2.5 mm)

BLK1000FL

Simple NFPA 101 Emergency Lighting, Anywhere AND Connected



FirstLink

The BLK1000FL is equipped with FirstLink connectivity. FirstLink makes testing and reporting the status of a facility's emergency lighting system quick and easy. The FirstLink application enables the interconnection of FirstLink compatible exit signs, unit equipment, and emergency drivers and allows for the collection of product test results, the collation of that data into reports, and additional controls over the devices. For full details on what FirstLink and the FirstLink application can do, please see the [FirstLink Application Guide](#).

The FirstLink app is available for iOS and Android smart phones and can be found on either the Apple App or Google Play store.

Application & Operation

The BLK1000FL Emergency Lighting Kit is UL Classified for factory or field installation and allows for NFPA 101 compliant emergency lighting to be added to most new or existing luminaires, in the field or in a factory setting. This emergency lighting kit consists of electronic circuitry and a high-temperature maintenance-free lithium-ion battery, contained in one metal enclosure, an LED module light source, and installation kit.

When AC power fails, the BLK1000FL kit immediately switches to the emergency mode, using the internal battery to illuminate the included LED module. When operating from battery power, the BLK1000FL kit is capable of delivering 1000 initial lumens and shall operate for a minimum of 90 minutes. When AC power is restored, the emergency lighting kit automatically returns to the charging mode and ceases to illuminate the kit's LED module. If used in an emergency-only fixture, no AC driver is necessary.

ABConnect

ABConnect (Automatic Bodine Connect) simplifies shipping, storage, installation, and commissioning of the emergency lighting luminaire. It allows for the luminaire to be installed and made ready for use without needing to reopen the luminaire when AC power is available, also avoiding unnecessary drain on the battery. Once activated, the product can also be manually disabled, allowing the product or the luminaire to be safely stored for extended periods of time. In the situation where the user manually deactivates the emergency operation for shipping or storing product via the test switch, the Automatic Bodine Connect feature reactivates power when the driver senses that AC current is applied. This feature saves time, labor and the potential to overlook the converter connector step. This reduces the possibility of inadvertently discharging the battery prior to installation, whether in transit or storage.

Installation

The BLK1000FL kit does not affect normal fixture operation and may be used with either a switched or unswitched fixture. If a switched fixture is used, an unswitched hot lead must be connected to the emergency driver. The BLK1000FL kit driver must be fed from the same branch circuit as the luminaire in which it is installed. Installation is not recommended with fixtures where the ambient temperature may fall below 0°C or climb above 55°C. The illuminated test switch (ITS) is a class 2 device. The BLK1000FL kit is suitable for indoor and damp locations, and for installation in sealed and gasketed fixtures, including fixtures rated for wet locations. For more information about specific luminaire compatibility, please contact Technical Support.

BLK1000FL Kit Includes

- 1 x Emergency LED driver with integral battery
- 1 x 1000 lumen LED module
- 1 x Caution/charge indication/test switch label
- 1 x Plenum rated LED module harness - 37" (960mm)
- 1 x AC hook up wire set (black and white) - 27" (690mm), 18 AWG, solid
- 4 x Self tapping mounting screws - 3/8"
- 1 x FirstLink bracket with integral bi-color illuminated test switch and communication node

Code Compliance

The BLK1000FL complies with Part 15 of the FCC Regulations and meets CEC Title 20 (California Energy Commission) battery charging efficiency regulations. The emergency lighting kit shall be UL 924 Classified for factory or field installation in the US or Canada. Output LED load and ITS connections are all rated Class 2 per UL 1310. Faults in the system detected by self-tests will be indicated by the flashing of the ITS. Depending on your local code requirements, the status of the ITS should be checked monthly to ensure there has been no fault found during regular self-tests. Installing the BLK1000FL emergency lighting retrofit kit in a Listed luminaire does not affect the luminaire Listing.

Specification

Emergency lighting shall be provided by using a luminaire equipped with a Bodine BLK1000FL Emergency Lighting Kit (emergency driver, LED module and accessories). The emergency driver shall consist of a high-temperature maintenance-free lithium-ion battery, charger, and other electronic circuitry contained in one metal enclosure. Electronic circuitry shall be self-testing in design and automatically test emergency lighting for a minimum of 30 seconds every 28 days and 90 minutes once a year. A polymer bracket with 2-wire, bi-color, illuminated test switch (ITS) and FirstLink communication node shall be supplied with the installation hardware needed to install the emergency lighting kit in most standard luminaires and connect to a local FirstLink emergency device network. The BLK1000FL kit is capable of delivering 1000 lumens initially to the included LED module for a minimum of 90 minutes. The BLK1000FL kit is suitable for indoor and damp locations, and for installation in sealed and gasketed fixtures, including fixtures rated for wet locations. The BLK100 driver shall comply with emergency standards set forth by the current NEC. The BLK1000FL shall be self-testing (selectable) to comply with NFPA 101. This device shall also comply with Part 15 of the FCC Rules and meet CEC Title 20 (California Energy Commission) efficiency standards. The BLK1000FL kit shall be UL Classified for factory or field installation in the US and Canada.

Warranty

Model BLK1000FL is warranted for five (5) full years from date of manufacture. Please see detailed warranty information on our website.

BLK1000FL

Simple NFPA 101 Emergency Lighting, Anywhere AND Connected

Additional Drawings

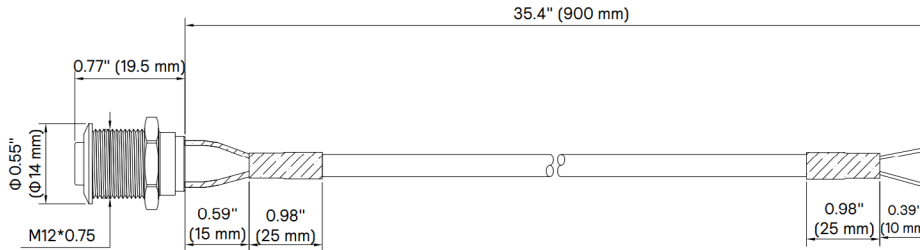

Communication node and test switch/indicator light bracket.

Note: Requires 1.75" hole for proper mounting in ceiling tile or plaster ceiling.

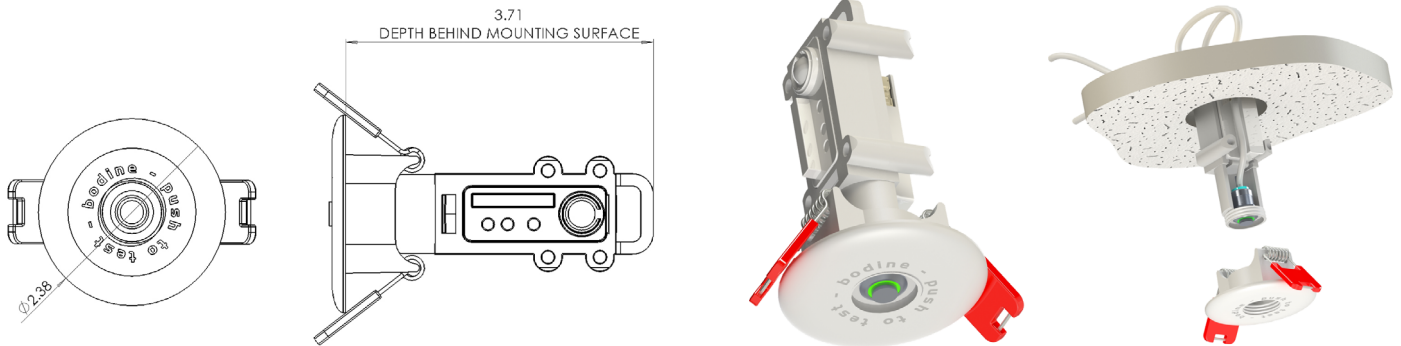

Ordering Guide

Product Category	Lumens	Case	Input Voltage	Temperature		Special Features	Generation
				K	55		
BLK	1000	T3	U	K	55	FL	1
BLK Bodine Lighting Kit	1000	T3 (see page 1 for case dimensions)	U 120-277V	K Min. Temp 0° C	55 Max. Temp 55° C	FL FirstLink	1

example: BLK1000T3UK55FL1

BLK1000FL

Simple NFPA 101 Emergency Lighting, Anywhere AND Connected

Wiring Diagram

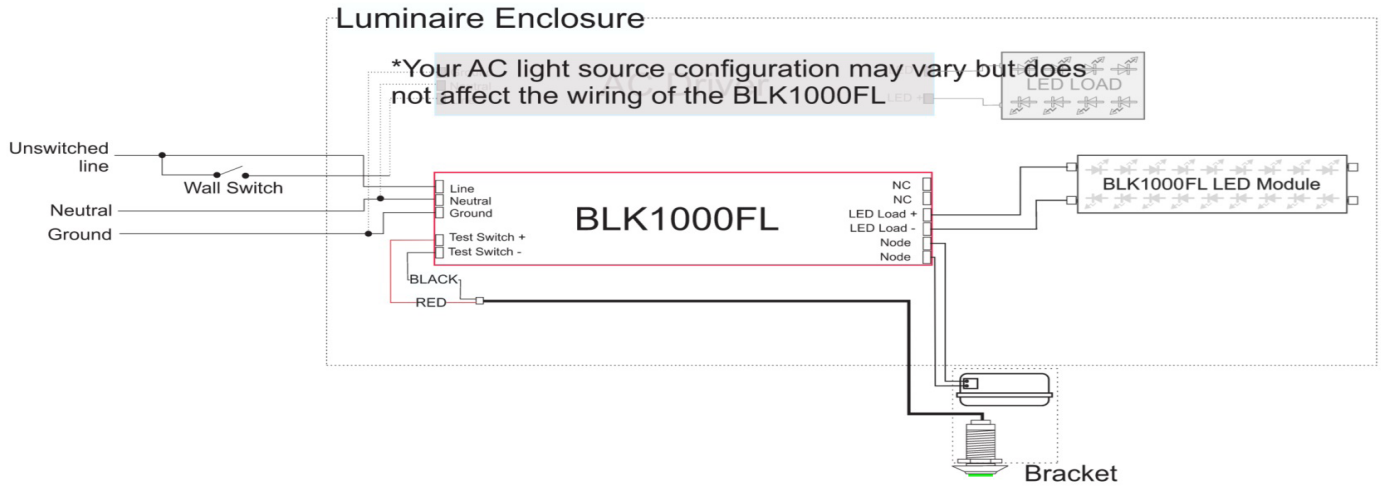

For illustration purposes only. Refer to product installation instructions for actual wiring diagram and proper connection points.

Lithium Battery Shipping Regulations

To comply with IATA provisions for air transporting lithium batteries, and for general information on shipping Li-ion batteries, please visit <https://www.iata.org/en/programs/cargo/dgr/lithium-batteries/>.

To view a Classification Flowchart for package marking requirements, please visit <https://www.iata.org/contentassets/05e6d8742b0047259bf3a700bc9d42b9/lithium-battery-guidance-document.pdf>. Scroll to the Classification Flowchart on Page 7 of the 2023 version of this document. The BLK1000 battery cell capacity is less than 20Wh, and the battery pack capacity is less than 100 Wh.

The information presented in this document is not intended as any commercial offer and does not form part of any quotation or contract.



© 2024 Signify Holding. All rights reserved. The information provided herein is subject to change, without notice. Signify does not give any representation or warranty as to the accuracy or completeness of the information included herein and shall not be liable for any action in reliance thereon. The information presented in this document is not intended as any commercial offer and does not form part of any quotation or contract, unless otherwise agreed by Signify.

Signify North America Corporation
400 Crossing Blvd, Suite 600
Bridgewater, NJ 08807
Telephone: 855-486-2216

Signify Canada Ltd.
281 Hillmount Road,
Markham, ON, Canada L6C 2S3
Telephone: 800-668-9008

All trademarks are owned by Signify Holding or their respective owners.